

## READ CAREFULLY BEFORE INSTALLING

- for INDOOR USE ONLY
- check projection position before installing the lift
- it is normal for the motor to run hot during use of the lift
- incorrect use of the lift (e.g. exceeding maximum weight) can be dangerous. Beamax can not be held responsible for accidents due to incorrect use of the projector lift.
- The lift is driven by a 230V AC motor. DO NOT attempt to service the motor as it may lead to ELECTRICAL SHOCK if done incorrectly
- Repairs should be carried out by professionals

## PARTS INCLUDED:

- A. Mechanic projector lift supplied with a plastic raceway and motor with a cable of 3 meters long with 4 electrical wires
- B. 4 "L" form aluminium brackets for ceiling mounting
- C. on/off switch unit ( for wiring instructions, see last page)
- D. 4 threaded bars M6 of 25 cm and 2 mounting plates for the false ceiling plate
- E. 8 hex head screws 6x16 mm
- F. 16 nuts M6 for mounting the threaded bars to the mounting plates and to the lift

**NOT INCLUDED** : bolts/screws for attachment to the ceiling

## INSTRUCTIONS FOR INSTALLATION

1. Use the HEX screws (F) to mount the "L" brackets to the profile of the lift, as shown in the following two pictures.



2. Mount the lift to the ceiling with suitable bolts/screws (NOT INCLUDED) and verify that the projector lift is perfectly horizontal using a spirit level. Use shims to level the lift if required between the brackets and ceiling.

Mounting the lift level guarantees a silent movement of the lift without any shaking, jolting or friction that would compromise the alignment between projector and projection screen.

3. Once you have mounted the lift, position the projector either on or under the grill using the screws indicated on the instruction manual of your projector, as shown below.

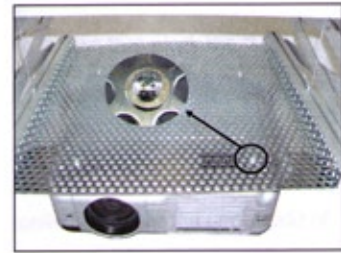
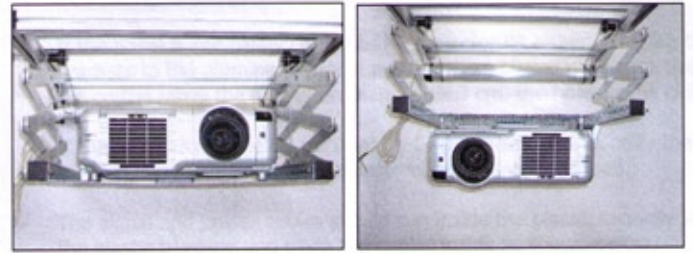

4. Connect the projector lift to the electricity supply as explained on the last page (3/3) of this document.

5. The next step is to set the "CLOSED STOP POSITION" (CLOSED lift) and the "BOTTOM STOP POSITION" (OPEN lift).

If the projector lift has been positioned inside a false ceiling please be aware that to allow full closure, the threaded bars that support the trim kit must be no longer than 25 cm in length.

The "BOTTOM STOP POINT" has to be regulated so that the image is correctly projected onto the screen.

In order to fix the "CLOSED STOP POSITION":

- turn the white screw anticlockwise in order to position the lift nearer to the ceiling. Clockwise increases the stop point.

In order to fix the "BOTTOM STOP POINT":

- turn the yellow screw anticlockwise to increase the drop and clockwise to reduce the drop.

6. Once you have fixed the "CLOSED STOP POSITION", cut the threaded bars to the correct length to allow flush fitting of the trim kit suspended from the grill to the ceiling. Mount the bars to the profile of the lift and fix them also to the mounting plates, using the M6 nuts supplied, as on the pictures below.

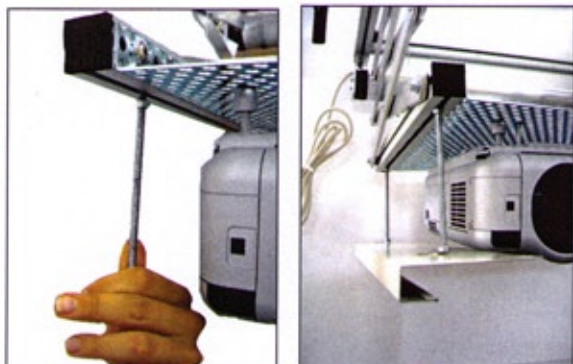

7. Fit and align the trim kit by hanging the threaded rods from the slot as shown on the picture above.

8. If the panel is not balanced, move the projector lift by either releasing the screws that block the "L" brackets to the aluminium profile making them to slide or releasing the screws that anchor the brackets to the ceiling using the milling on them (max. 3 cm, the hole on the ceiling is central).

If the lift does not line up horizontally to the false ceiling modify the length of the bars or the "CLOSED STOP POSITION", following the instructions above described.

9. The signal and power cables should run inside the plastic raceway supplied. Remove the upper side of the plastic trunking and place the cables inside as shown below.

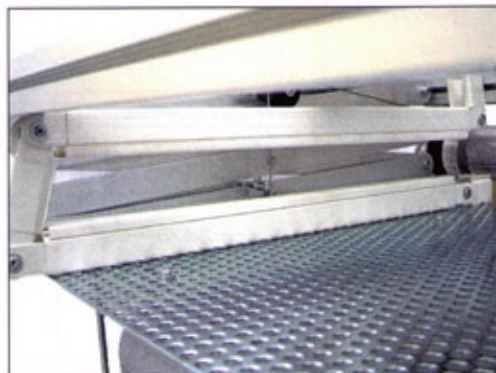

# 10635 INSTALLATION MANUAL BEAMAX PROJECTOR LIFT WIRING & TECHNICAL DATA

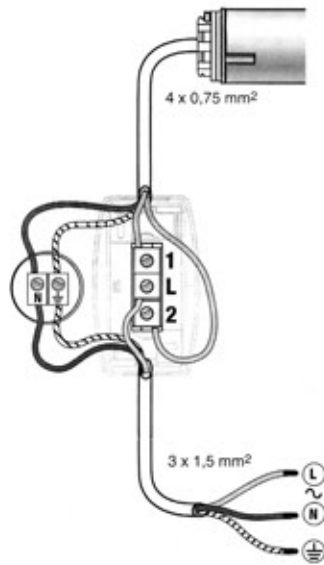
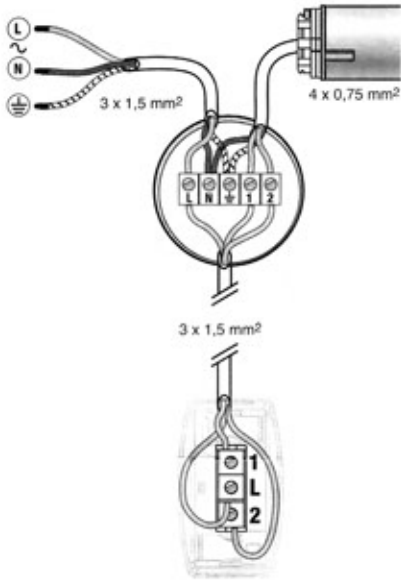
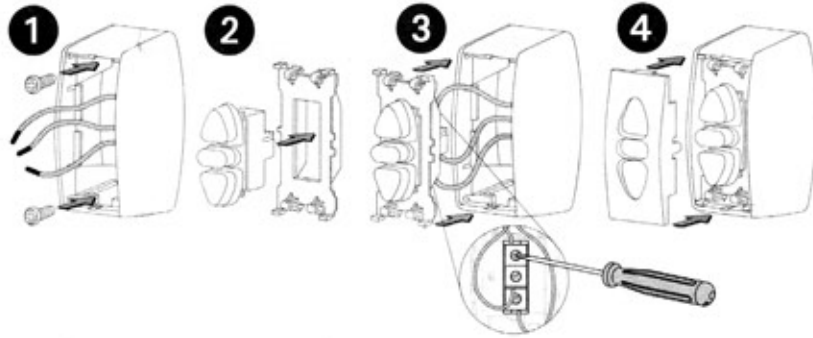

TERMINALS	POWERSUPPLY	MOTOR (EUR)	MOTOR (US)
L	PHASE (L)	BLUE	WHITE
N	NEUTRAL (N)	YELLOWGREEN	GREEN
⊕	EARTH	BLACK or BROWN	BLACK or RED
1		BLACK or BROWN	BLACK or RED
2		BLACK or BROWN	BLACK or RED

- Disconnect the main supply before carrying out any work
- Ensure that no forces act on terminals after installation
- Connect the earth wires before phase and neutral

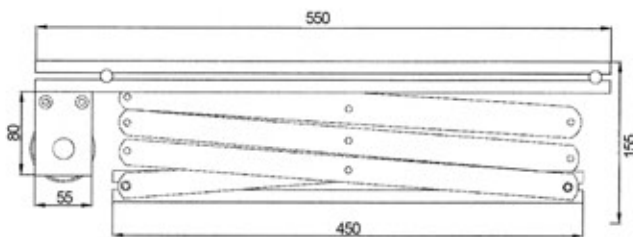
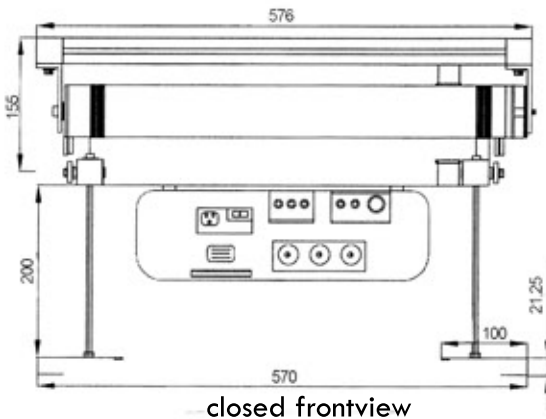

**power supply**  
230 V 50Hz  
**max consumption**  
90 W  
**motor**  
8 Nm / 12 rpm  
**dimensions (closed) (hwxwd in mm)**  
576 x 155 x 550  
**dimensions (open) (hwxwd in mm)**  
576 x 1023 x 550  
**dimensions of the grill (hxd in mm)**  
415 x 450  
**maximum capacity**  
15 kg

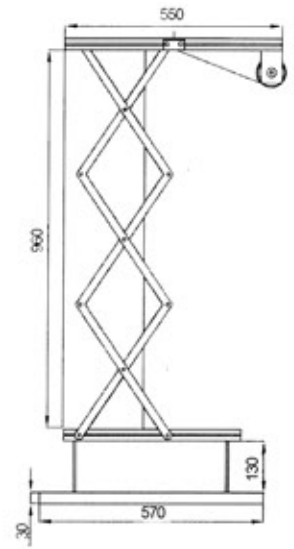

open sideview